



**SUMINISTROS
INDUSTRIALES
DÍAZ**

CATÁLOGO

FORGED STEEL & FITTINGS UNIONS



VISÍTENOS EN:

*Av. Puebla 515 Col. Palma Sola, CP 93320.
Poza Rica Veracruz, México*

Teléfonos: 7821606595, 7821604051 y 7821610766



contacto@sidadz.com



www.sidadz.com





CLASS 3000

CLASS 6000

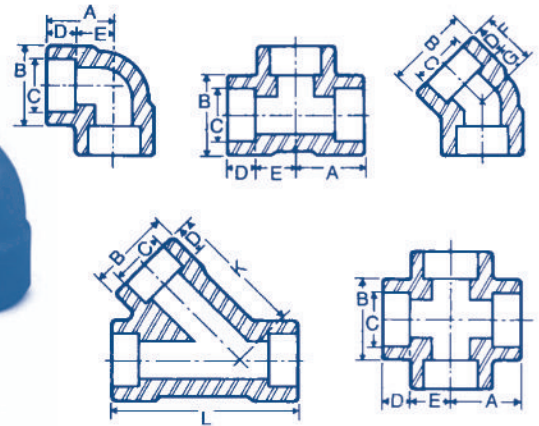
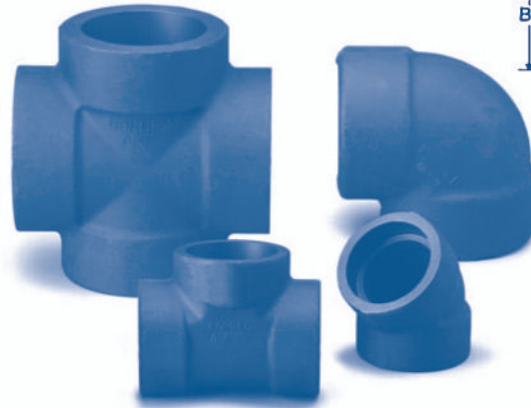

DIMENSIONS (Inches)													
NOMINAL PIPE SIZE	1/8	1/4	3/8	1/2	3/4	1	1 1/4	1 1/2	2	2 1/2	3	4	
90EL TEE LAT (MIN.) D	A	7/8	7/8	31/32	1 1/8	15/16	1 1/2	1 3/4	2	2 3/8	3	3 3/8	4 3/16
	B	29/32	29/32	1 1/16	1 5/16	1 9/16	1 27/32	2 7/32	2 1/2	3 1/32	3 11/16	4 5/16	5 3/4
	D	3/8	3/8	3/8	3/8	3/8	1/2	1/2	1/2	5/8	5/8	5/8	3/4
45EL CROSS (MIN.) D	A	7/8	7/8	31/32	1 1/8	15/16	1 1/2	1 3/4	2	2 3/8	3 1/4	3 3/4	4 1/2
	B	29/32	29/32	1 1/16	1 5/16	1 9/16	1 27/32	2 7/32	2 1/2	3 1/32	4	4 3/4	6
	D	3/8	3/8	3/8	3/8	1/2	1/2	1/2	1/2	5/8	5/8	5/8	3/4
E	7/16	7/16	17/32	5/8	3/4	7/8	1 1/16	1 1/4	1 1/2	1 5/8	2 1/4	2 5/8	
F	3/4	3/4	3/4	1	1 1/8	1 1/4	1 5/16	1 3/8	1 11/16	2 1/16	2 1/2	3 1/8	
G	5/16	5/16	5/16	7/16	1/2	9/16	11/16	13/16	1	1 1/8	1 1/4	1 5/8	
H	1 1/4	1 1/4	1 1/2	1 5/8	1 7/8	2 1/4	2 5/8	2 15/16	3 5/16				
J	7/8	7/8	1	1 1/8	1 3/8	1 3/4	2	2 1/8	2 1/2				
K			1 7/8	2 1/8	2 9/16	3	3 1/2	3 15/16	4 3/4				
L			2 11/16	3	3 9/16	4 1/8	4 13/16	5 3/8	6 7/16				
DIMENSIONS C (common to all fittings)		.420	.555	.690	.855	1.065	1.330	1.675	1.915	2.406	2.906	3.535	4.545
WEIGHT (pounds)													
90° ELBOW	.125	.183	.270	.460	.698	.987	1.480	2.088	3.125	6.340	10.867	25.00	
45° ELBOW	.125	.198	.210	.440	.673	.935	1.365	1.63	2.71	6.75	10.50	18.188	
TEE	.25	.25	.345	.540	.925	1.307	2.00	2.640	4.070	8.75	12.50	27.80	
STREET ELBOW	.25	.25	.375	.50	.875	1.438	2.25	3.00	5.188				
LATERAL		.25	.625	1.00	1.500	2.375	3.75	4.125	6.285				
CROSS	.25	.25	.375	.813	1.125	1.550	2.25	3.063	5.125	18.00	23.00	40.00	

DIMENSIONS (Inches)													
NOMINAL PIPE SIZE	1/8	1/4	3/8	1/2	3/4	1	1 1/4	1 1/2	2	2 1/2	3	4	
A	7/8	31/32	1 1/8	1 5/16	1 1/2	1 3/4	2	2 3/8	2 1/2	3 1/4	3 3/4	4 1/2	
B	29/32	1 1/16	1 5/16	1 9/16	1 27/32	2 7/32	2 1/2	3 1/32	3 11/32	4	4 3/4	6	
(MIN.) D	3/8	3/8	3/8	3/8	1/2	1/2	1/2	1/2	5/8	5/8	5/8	3/4	
E	7/16	17/32	5/8	3/4	7/8	1 1/16	1 1/4	1 1/2	1 5/8	2 1/4	2 1/2	2 3/4	
F	3/4	3/4	1	1 1/8	1 1/4	1 5/16	1 3/8	1 11/16	1 3/4	2 1/16	2 1/2	3 1/8	
G	5/16	5/16	7/16	1/2	9/16	11/16	13/16	1	1 1/8	1 1/4	1 3/8	1 5/8	
H	1 1/4	1 1/2	1 5/8	1 7/8	2 1/4	2 5/8	2 15/16	3 5/16					
J	7/8	1	1 1/8	1 3/8	1 3/4	2	2 1/8	2 1/2					
K			2 1/8	2 9/16	3	3 1/2	3 15/16	4 3/4	5				
L			3	3 9/16	4 1/8	4 13/16	5 3/8	6 7/16	6 5/8				
DIMENSIONS C (common to all fittings)		.420	.555	.690	.855	1.065	1.330	1.675	1.915	2.406	2.906	3.535	4.545
WEIGHT (pounds)													
90° ELBOW				.938	1.440	2.348	3.188	5.25	6.660	11.875	19.25	32.70	
45° ELBOW				.875	1.313	1.913	2.27	4.313	4.813	9.625	14.25	27.25	
TEE				1.375	2.00	3.313	3.75	7.480	8.240	16.625	23.50	33.00	
STREET ELBOW		.375	.438	1.00	1.625	2.50	3.688	6.438					
LATERAL				2.00	3.063	5.125	6.25	11.938	12.5				
CROSS				1.50	2.50	3.460	5.25	8.75	9.438	20.25	27.00	39.00	





CLASS 9000

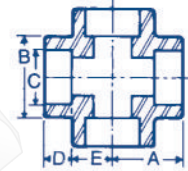
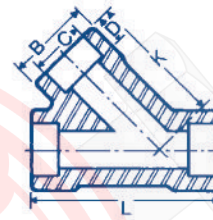
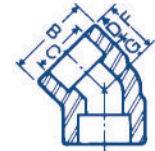
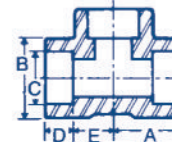
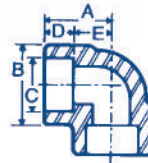
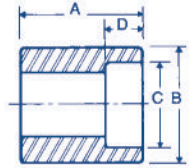
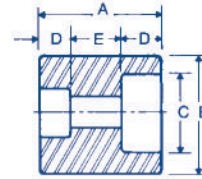
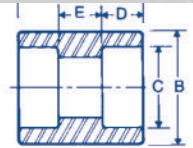
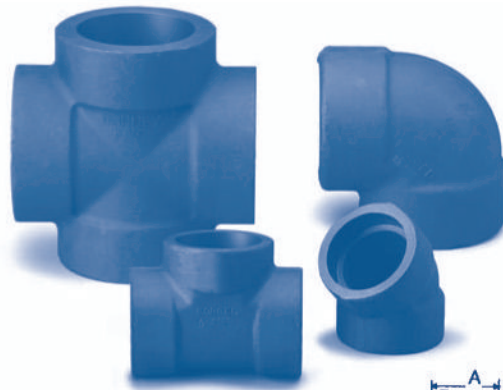

CLASS 9000 XXS BORE- 90° ELBOW						
DIMENSIONS (Inches)						
NOMINAL PIPE SIZE	1/2	3/4	1	1 1/4	1 1/2	2
A	1 1/2	1 3/4	2	2 3/8	2 1/2	3
B	1 27/32	2 7/32	2 1/2	3 1/32	3 11/32	3 11/16
(MIN.) D	3/8	1/2	1/2	1/2	1/2	5/8
E	1	1 1/8	1 1/4	1 3/8	1 1/2	2 1/8
WEIGHT (pounds)						
Weight	1.44	2.25	3.19	5.25	6.69	6.69

CLASS 9000 XXS BORE- TEE						
DIMENSIONS (Inches)						
NOMINAL PIPE SIZE	1/2	3/4	1	1 1/4	1 1/2	2
A	1 1/2	1 3/4	2	2 3/8	2 1/2	3
B	1 27/32	2 7/32	2 1/2	3 1/32	3 11/32	3 11/16
(MIN.) D	3/8	1/2	1/2	1/2	1/2	5/8
E	1	1 1/8	1 1/4	1 3/8	1 1/2	2 1/8
WEIGHT (pounds)						
Weight	2.00	3.31	3.75	6.50	7.88	8.75

CLASS 9000 XXS BORE- 45° ELBOW						
DIMENSIONS (Inches)						
NOMINAL PIPE SIZE	1/2	3/4	1	1 1/4	1 1/2	2
B	1 27/32	2 7/32	2 1/2	3 1/32	3 3/8	4
(MIN.) D	5/8	9/16	9/16	13/16	3/4	15/16
F	1 1/4	1 5/16	1 3/8	1 11/16	1 3/4	2 1/16
G	5/8	3/4	13/16	7/8	1	1 1/8
WEIGHT (pounds)						
Weight	1.31	2.06	2.50	4.31	4.81	9.62

CLASS 9000 XXS BORE- LATERAL						
DIMENSIONS (Inches)						
NOMINAL PIPE SIZE	1/2	3/4	1	1 1/4	1 1/2	2
B	1 27/32	2 7/32	2 1/2	3 1/32	3 11/32	
(MIN.) D	9/16	5/8	11/16	7/8	7/8	
K	3	3 1/2	3 15/16	4 3/4	5	
L	4 1/8	4 13/16	5 3/8	6 7/16	6 5/8	
WEIGHT (pounds)						
Weight	1.75	2.38	3.75	6.88	6.88	

DIMENSIONS C - COMMON TO ALL FITTINGS (inches)						
NOMINAL PIPE SIZE	1/2	3/4	1	1 1/4	1 1/2	2
C	.855	1.065	1.330	1.675	1.915	2.406

CLASS 9000 XXS BORE- CROSS						
DIMENSIONS (inches)						
NOMINAL PIPE SIZE	1/2	3/4	1	1 1/4	1 1/2	2
A	1 1/2	1 3/4	2	2 3/8	2 1/2	3 1/4
B	1 27/32	2 7/32	2 1/2	3 1/32	3 11/32	4
(MIN.) D	1/2	5/8	3/4	1	1	1 1/8
E	1	1 1/8	1 1/4	1 3/8	1 1/2	2 1/8
WEIGHT (pounds)						
Weight	2.50	4.12	4.12	5.12	9.44	22.19

CLASS 9000 XXS BORE- COUPLINGS- REDUCERS- HALF COUPLING						
DIMENSIONS (inches)						
NOMINAL PIPE SIZE	1/2	3/4	1	1 1/4	1 1/2	2
A	1 3/8	1 1/2	1 3/4	1 7/8	2	2 1/2
B	1 13/16	2	2 3/8	2 3/4	3 1/16	3 5/8
(MIN.) D	1/2	9/16	5/8	11/16	3/4	7/8
E	3/8	3/8	1/2	1/2	1/2	3/4
F						
WEIGHT (pounds)						
Coupling	.75	1.06	1.69	2.22	2.81	4.66
Reducer	.75	1.06	1.69	2.22	2.81	4.66
Half Coupling	.88	1.16	1.88	2.50	3.25	5.38





CLASS 2000

CLASS 3000

CLASS 6000

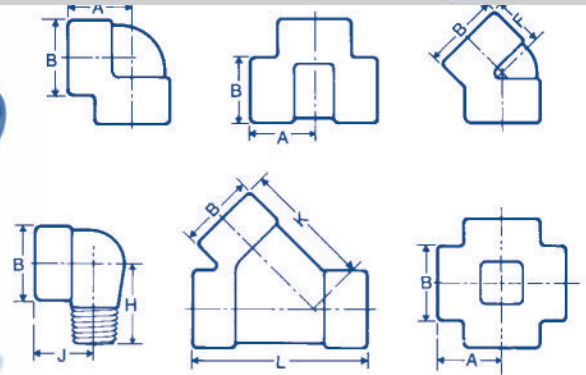

		DIMENSIONS (inches)													
		NOMINAL PIPE SIZE	1/8	1/4	3/8	1/2	3/4	1	1 1/4	1 1/2	2	2 1/2	3	4	
CLASS 2000	90EL TEE	A		7/8	31/32	1 1/8	1 5/16	1 1/2	1 3/4	2	2 3/8	3	3 3/8	4 3/16	
		B		29/32	1 1/16	1 5/16	1 9/16	1 27/32	2 7/32	2 1/2	3 1/32	3 11/16	4 5/16	5 3/4	
		F		3/4	3/4	1	1 1/8	1 1/4	1 5/16	1 3/8	1 11/16	2 1/16	2 1/2	3 1/8	
	45EL CROSS	A		7/8	31/32	1 1/8	1 5/16	1 1/2	1 3/4	2	2 3/8	3 1/4	3 3/4	4 1/2	
		B		29/32	1 1/16	1 5/16	1 9/16	1 27/32	2 7/32	2 1/2	3 1/32	4	4 3/4	6	
		F		3/4	3/4	1	1 1/8	1 1/4	1 5/16	1 3/8	1 11/16	2 1/16	2 1/2	3 1/8	
	WEIGHT (pounds)														
		90° ELBOW	.25	.198	.283	.500	.773	1.013	1.550	2.180	3.140	6.50	10.925	26.675	
		45° ELBOW	.125	.188	.236	.435	.740	1.058	1.375	1.740	2.883	7.75	11.313	19.125	
		TEE	.25	.267	.373	.613	.963	1.355	2.030	2.800	4.456	9.530	12.908	28.700	
		CROSS	.50	.50	.460	.777	1.125	1.688	2.450	3.188	5.560	16.438	19.50	32.688	

		DIMENSIONS (inches)													
		NOMINAL PIPE SIZE	1/8	1/4	3/8	1/2	3/4	1	1 1/4	1 1/2	2	2 1/2	3	4	
CLASS 3000	90EL TEE	A	7/8	31/32	1 1/8	1 5/16	1 1/2	1 3/4	2	2 3/8	2 1/2	3 1/4	3 3/4	4 1/2	
		B	29/32	1 1/16	1 5/16	1 9/16	1 27/32	2 7/32	2 1/2	3 1/32	3 11/32	4	4 3/4	6	
		F	3/4	3/4	1	1 1/8	1 1/4	1 5/16	1 3/8	1 11/16	1 3/4	2 1/16	2 1/2	3 1/8	
		H	1 1/4	1 1/4	1 1/2	1 5/8	1 7/8	2 1/4	2 5/8	2 15/16	3 5/16				
	45EL CROSS	J	7/8	7/8	1	1 1/8	1 3/8	1 3/4	2	2 1/8	2 1/2				
		K		1 7/8	2 1/8	2 9/16	3	3 1/2	3 15/16	4 3/4	5				
		L		2 11/16	3	3 9/16	4 1/8	4 13/16	5 3/8	6 7/16	6 5/8				
	WEIGHT (pounds)														
		90° ELBOW	.236	.350	.592	.973	1.355	2.265	2.407	3.50	5.920	11.900	14.438	31.975	
		45° ELBOW	.25	.290	.50	.75	1.188	1.988	2.235	3.00	4.930	7.375	13.558	19.063	
		TEE	.325	.460	.753	1.270	1.830	3.025	3.620	7.040	7.550	13.125	23.100	40.000	
	STREET ELBOW	.264	.242	.375	.595	1.048	1.438	2.340	3.00	5.461					
	LATERAL		.625	1.313	1.75	2.75	4.625	5.50	10.813	11.5					
	CROSS	.438	.567	.970	1.50	2.50	3.620	4.125	6.50	8.125	16.75	25.675	32		

		DIMENSIONS (inches)												
		NOMINAL PIPE SIZE	1/8	1/4	3/8	1/2	3/4	1	1 1/4	1 1/2	2	2 1/2	3	4
CLASS 6000	90EL TEE	A	31/32	1 1/8	1 5/16	1 1/2	1 3/4	2	2 3/8	2 1/2	3 1/4	3 3/4	4 3/16	4 1/2
		B	1 1/16	1 5/16	1 9/16	1 27/32	2 7/32	2 1/2	3 1/32	3 11/32	4	4 3/4	5 3/4	6
		F	3/4	1	1 1/8	1 1/4	1 5/16	1 3/8	1 11/16	1 3/4	2 1/16	2 1/2	3 1/8	3 1/8
		H	1 1/4	1 1/2	1 5/8	1 7/8	2 1/4	2 5/8	2 15/16	3 5/16				
	45EL CROSS	A	31/32	1 1/8	1 5/16	1 1/2	1 3/4	2	2 3/8	2 1/2	3 1/4	3 3/4	4 1/2	4 1/2
		B	1 1/16	1 5/16	1 9/16	1 27/32	2 7/32	2 1/2	3 1/32	3 11/32	4	4 3/4	6	6
		F	3/4	1	1 1/8	1 1/4	1 5/16	1 3/8	1 11/16	1 3/4	2 1/16	2 1/2	3 1/8	3 1/8
	STREET ELBOW	J	7/8	1	1 1/8	1 3/8	1 3/4	2	2 1/8	2 1/2				
		K		2 9/16	3	3 1/2	3 15/16	4 3/4	5					
		L		3 9/16	4 1/8	4 13/16	5 3/8	6 7/16	6 5/8					
	WEIGHT (pounds)													
	90° ELBOW	.25	.625	1.023	1.625	2.625	3.50	6.75	7.50	13.438	20.875	39.050	38	
	45° ELBOW	.25	.640	.50	1.438	2.188	2.785	4.688	5.75	9.50	15	30.563	29	
	TEE	.50	.853	1.410	2.150	3.563	4.625	7.625	9.625	18.500	28.063	47.500	50	
	STREET ELBOW		.375	.438	1	1.625	3.030	3.688	7.120					
	LATERAL			2.375	3.25	5.438	7.188	12.313	15.95					
	CROSS	.563	1.188	1.50	2.75	4.313	6.625	10.75	11.50	22.188	27.50	54	43.50	





CLASS 3000

CLASS 6000

STD-XSTG

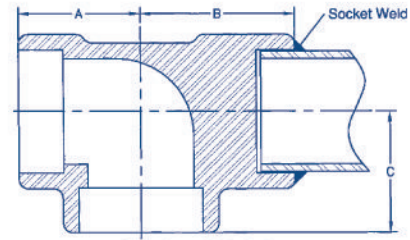
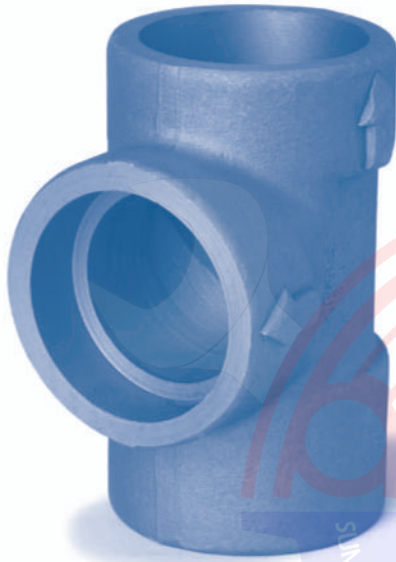

Socket Weld

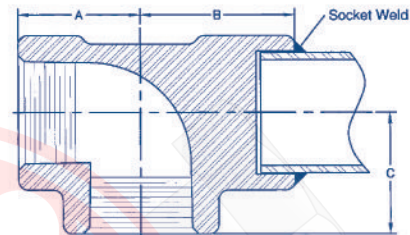

Threaded

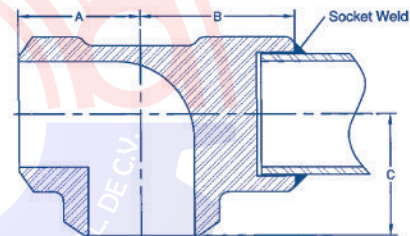

Butt Weld

CLASS 3000	DIMENSIONS (Inches)	SOCKET WELD						THREADED					
	NOMINAL PIPE SIZE	1/2	3/4	1	1 1/4	1 1/2	2	1/2	3/4	1	1 1/4	1 1/2	2
	A Nominal	-	1 1/2	1 1/2	1 3/4	2	2 3/8	1 1/2	1 1/2	1 3/4	2	2 3/8	2 1/2
	B Nominal	-	1 7/8	1 7/8	2 3/16	2 1/2	3	1 7/8	1 7/8	2 3/16	2 1/2	3	3 1/8
	C Nominal	-	1 1/2	1 1/2	1 3/4	2	2 3/8	1 1/2	1 1/2	1 3/4	2	2 3/8	2 1/2

CLASS 6000	DIMENSIONS (Inches)	SOCKET WELD						THREADED					
	NOMINAL PIPE SIZE	1/2	3/4	1	1 1/4	1 1/2	2	1/2	3/4	1	1 1/4	1 1/2	2
	A Nominal	-	1 1/2	1 3/4	2	2 3/8	2 1/2	1 1/2	1 3/4	2	2 3/8	2 1/2	-
	B Nominal	-	1 7/8	2 3/16	2 1/2	3	3 1/8	1 7/8	2 3/16	2 1/2	3	3 1/8	-
	C Nominal	-	1 1/2	1 3/4	2	2 3/8	2 1/2	1 1/2	1 3/4	2	2 3/8	2 1/2	-

STD-XSTG	DIMENSIONS (Inches)	BUTT WELD				
	NOMINAL PIPE SIZE	2	2 1/2	3	4	
	A Nominal	2 3/8	3	3 3/8	4 3/16	
	B Nominal	3	3	3 3/8	4 3/16	
	C Nominal	2 3/8	3	3 3/8	4 3/16	





CLASS 3000

CLASS 6000

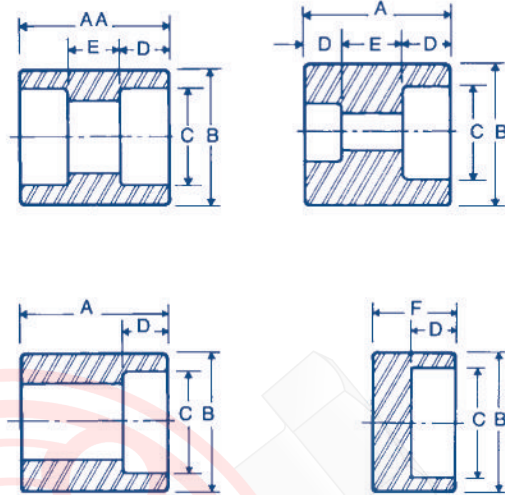
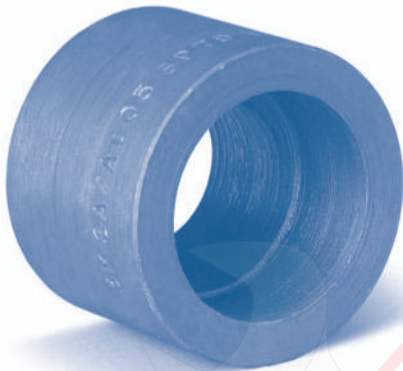

CLASS 3000												
DIMENSIONS (inches)												
NOMINAL PIPE SIZE	1/8	1/4	3/8	1/2	3/4	1	1 1/4	1 1/2	2	2 1/2	3	4
A	1 1/8	1 1/8	1 1/8	1 3/8	1 1/2	1 3/4	1 7/8	2	2 1/2	2 1/2	2 3/4	3
AA	1 1/32	1 1/32	1 1/32	1 9/64	1 13/32	1 33/64	1 33/64	1 33/64	2 1/64	2 1/64	2 1/64	2 17/64
B	3/4	7/8	1 1/16	1 1/4	1 1/2	1 13/16	2 1/4	2 1/2	3	3 5/8	4 5/16	5 1/2
C	.420	.555	.690	.855	1.065	1.330	1.675	1.915	2.406	2.906	3.535	4.545
D	7/16	7/16	7/16	1/2	9/16	5/8	11/16	3/4	7/8	7/8	1	1 1/8
E	1/4	1/4	1/4	3/8	3/8	1/2	1/2	1/2	3/4	3/4	3/4	3/4
F	11/16	3/4	3/4	7/8	1	1 1/16	1 3/16	1 1/4	1 1/2	1 9/16	1 13/16	2 1/16
WEIGHT (pounds)												
COUPLING	.125	.125	.125	.188	.313	.563	.813	1	2	2.625	3.875	6.625
REDUCER	.125	.125	.125	.188	.313	.563	.813	1	2	2.625	3.875	6.625
HALF COUPLING	.125	.125	.125	.188	.313	.563	.813	1	2	2.625	3.875	6.625
PIPE CAP	.063	.063	.125	.188	.313	.563	.813	1.125	1.688	3	3.625	6.688

CLASS 6000												
DIMENSIONS (inches)												
NOMINAL PIPE SIZE	1/4	3/8	1/2	3/4	1	1 1/4	1 1/2	2	2 1/2	3	4	
A	1 1/8	1 1/8	1 3/8	1 1/2	1 3/4	1 7/8	2	2 1/2	2 1/2	2 3/4	3	
AA	1 1/8	1 1/8	1 5/32	1 13/32	1 33/64	1 33/64	1 33/64	2 1/64	2 1/64	2 1/64	2 17/64	
B	1 1/16	1 5/16	1 1/2	1 3/4	2 1/4	2 1/2	3	3 5/8	4 1/4	5	6 1/4	
C	.555	.690	.855	1.065	1.330	1.675	1.915	2.406	2.906	3.535	4.545	
D	7/16	7/16	1/2	9/16	5/8	11/16	3/4	7/8	7/8	1	1 1/8	
E	1/4	1/4	3/8	3/8	1/2	1/2	1/2	3/4	3/4	3/4	3/4	
F	15/16	15/16	1	1 1/16	1 1/4	1 5/16	1 3/8	1 5/8	1 11/16	1 15/16	2 5/16	
WEIGHT (pounds)												
COUPLING			.375	.563	1	1.438	2	3.875	5.50	6.625	13.125	
REDUCER			.375	.563	1	1.438	2	3.875	5.50	6.625	13.125	
HALF COUPLING			.375	.563	1	1.438	2	3.875	5.50	6.625	13.125	
PIPE CAP			.375	.50	1.125	1.125	2.25	3.50	5.625	6	13.50	





CLASS 3000

CLASS 6000

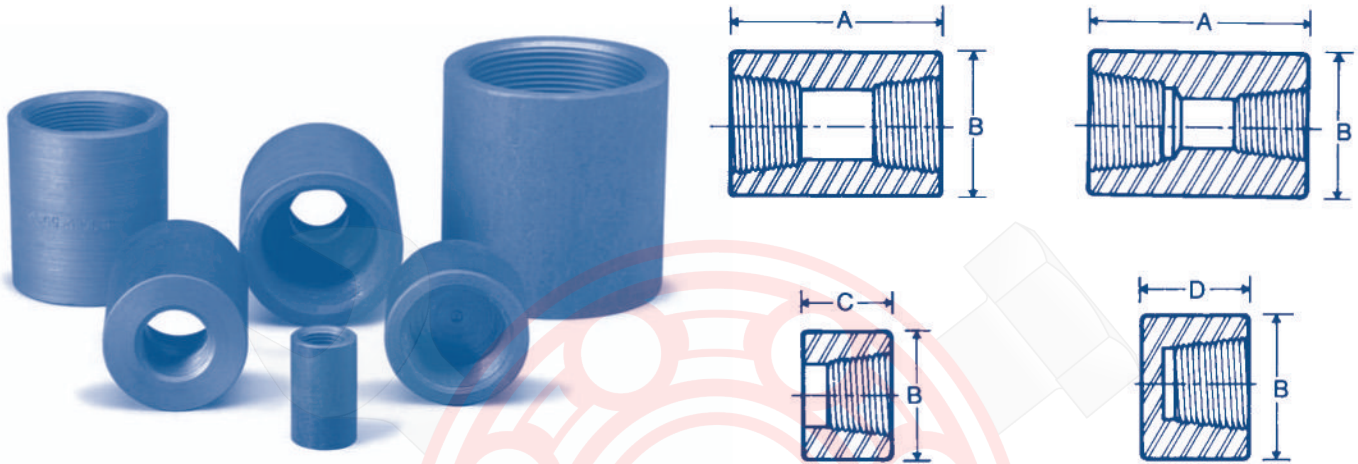

CLASS 3000												
DIMENSIONS (inches)												
NOMINAL PIPE SIZE	1/8	1/4	3/8	1/2	3/4	1	1 1/4	1 1/2	2	2 1/2	3	4
A	1 1/4	1 3/8	1 1/2	1 7/8	2	2 3/8	2 5/8	3 1/8	3 3/8	3 5/8	4 1/4	4 3/4
B	3/4	3/4	7/8	1 1/8	1 3/8	1 3/4	2 1/4	2 1/2	3	3 5/8	4 1/4	5 1/2
C	5/8	11/16	3/4	15/16	1	1 3/16	1 5/16	1 9/16	1 11/16	1 13/16	2 1/8	2 3/8
D	15/16	1	1	1 1/4	1 7/16	1 5/8	1 3/4	1 3/4	1 7/8	2 3/8	2 9/16	2 11/16
WEIGHT (pounds)												
COUPLING	.125	.125	.25	.25	.438	.625	1.563	2.188	3.125	4	6.75	16.75
REDUCER	.125	.125	.25	.25	.438	.625	1.563	2.188	3.125	4	6.75	16.75
HALF COUPLING	.063	.063	.188	.188	.25	.313	.75	1.125	1.563	2	3.375	8.375
PIPE CAP	.031	.063	.125	.25	.313	.50	1	1.625	3.125	5	8.50	14

CLASS 6000												
DIMENSIONS (inches)												
NOMINAL PIPE SIZE	1/8	1/4	3/8	1/2	3/4	1	1 1/4	1 1/2	2	2 1/2	3	4
A	1 1/4	1 3/8	1 1/2	1 7/8	2	2 3/8	2 5/8	3 1/8	3 3/8	3 5/8	4 1/4	4 3/4
B	7/8	1	1 1/4	1 1/2	1 3/4	2 1/4	2 1/2	3	3 5/8	4 1/4	5	6 1/4
C	5/8	11/16	3/4	15/16	1	1 3/16	1 5/16	1 9/16	1 11/16	1 13/16	2 1/8	2 3/8
D	1	1 1/16	1 1/16	1 5/16	1 1/2	1 11/16	1 13/16	1 7/8	2	2 1/2	2 11/16	2 15/16
WEIGHT (pounds)												
COUPLING	.188	.188	.25	.50	1	2.125	2.375	4.375	7.75	10.75	13.50	24.50
REDUCER	.188	.188	.25	.50	1	2.125	2.375	4.375	7.75	10.75	13.50	24.50
HALF COUPLING	.094	.094	.125	.25	.50	1.063	1.188	2.188	3.875	5.375	6.75	12.25
PIPE CAP	.125	.125	.188	.313	.438	.75	1.313	1.688	3.25			





CLASS 3000

CLASS 6000

CLASS 9000

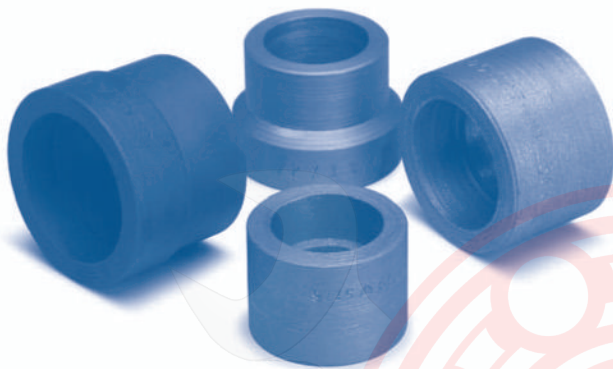

TYPE 1

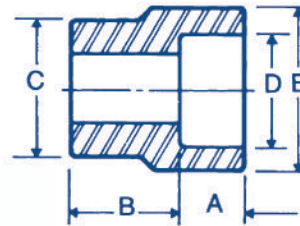

TYPE 2

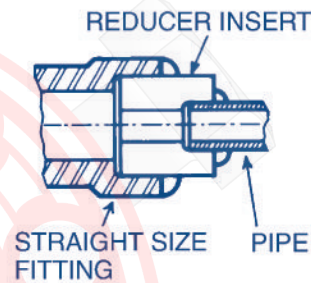
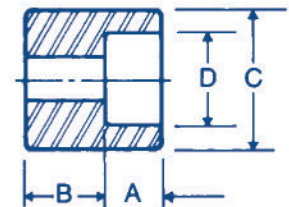

NOMINAL PIPE SIZE	CLASS 3000						CLASS 6000				CLASS 9000			
	C	D	Ftg. Type	A	B	E	Ftg. Type	A	B	E	Ftg. Type	A	B	E
3/8 x 1/4	.675	.555	1	7/16	3/4	15/16	1	7/16	7/8	1				
1/2 x 3/8	.850	.690	1	7/16	13/16	1 1/16	1	7/16	15/16	1 3/16				
1/2 x 1/4	.850	.555	1	7/16	13/16	15/16	1	7/16	7/8	1				
3/4 x 1/2	1.060	.855	1	7/16	7/8	15/16	1	7/16	1 1/16	1 3/8	1	7/16	13/16	1 3/4
3/4 x 3/8	1.060	.690	2	7/16	5/8	-	1	7/16	7/8	1 3/16				
3/4 x 1/4	1.060	.555	2	3/8	11/16	-	2	3/8	7/8	-				
1 x 3/4	1.325	1.065	1	9/16	15/16	1 1/2	1	9/16	1 1/8	1 11/16	1	9/16	1 1/4	2
1 x 1/2	1.325	.855	2	1/2	5/8	-	1	7/16	1 1/8	1 3/8	1	7/16	1 1/8	1 3/4
1 x 3/8	1.325	.690	2	7/16	11/16	-	2	1/2	7/8	-				
1 x 1/4	1.325	.555	2	3/8	3/4	-	2	3/8	15/16	-				
1 1/4 x 1	1.670	1.330	1	9/16	1	1 7/8	1	9/16	1 3/16	2	1	9/16	1 3/8	2 3/8
1 1/4 x 3/4	1.670	1.065	2	9/16	11/16	-	2	9/16	13/16	-	1	9/16	13/16	2
1 1/4 x 1/2	1.670	.855	2	1/2	3/4	-	2	1/2	7/8	-	2	1/2	7/8	-
1 1/4 x 3/8	1.670	.690	2	7/16	13/16	-	2	7/16	15/16	-				
1 1/4 x 1/4	1.670	.555	2	3/8	7/8	-	2	3/8	1	-				
1 1/2 x 1 1/4	1.910	1.675	1	9/16	1 1/8	2 1/4	1	9/16	1 3/8	2 3/8	1	9/16	1 5/8	2 3/4
1 1/2 x 1	1.910	1.330	2	5/8	11/16	-	1	9/16	1 3/16	2	1	9/16	1 3/8	2 3/8
1 1/2 x 3/4	1.910	1.065	2	9/16	3/4	-	2	9/16	1	-	2	9/16	1	-
1 1/2 x 1/2	1.910	.855	2	1/2	13/16	-	2	1/2	1 1/16	-	2	9/16	1	-
1 1/2 x 3/8	1.910	.690	2	7/16	7/8	-	2	7/16	1 1/8	-				
2 x 1 1/2	2.385	1.915	1	9/16	1 1/4	2 1/2	1	9/16	1 7/8	2 11/16	1	9/16	2 1/16	3
2 x 1 1/4	2.385	1.675	2	11/16	13/16	-	2	7/8	15/16	-	1	9/16	2	2 3/4
2 x 1	2.385	1.330	2	5/8	7/8	-	2	13/16	1	-	2	13/16	1	-
2 x 3/4	2.385	1.065	2	9/16	15/16	-	2	3/4	1 1/16	-	2	3/4	1 1/16	-
2 x 1/2	2.385	.855	2	1/2	1	-	2	11/16	1 1/8	-	2	11/16	1 1/8	-

Note: Socket Weld Reducer Inserts comply fully with MSS-SP-79





CLASS 3000/6000

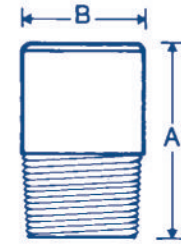

Round Head Plug

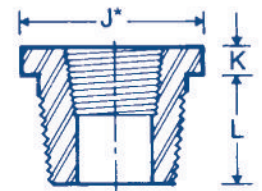

Hexagon Bushing

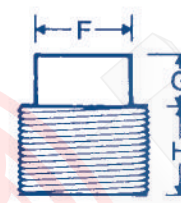

Square Head Plug

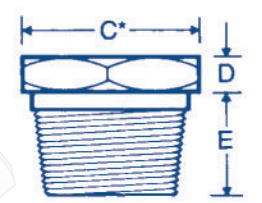

Hexagon Plug

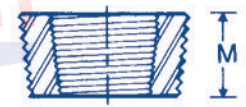

Flush Bushing

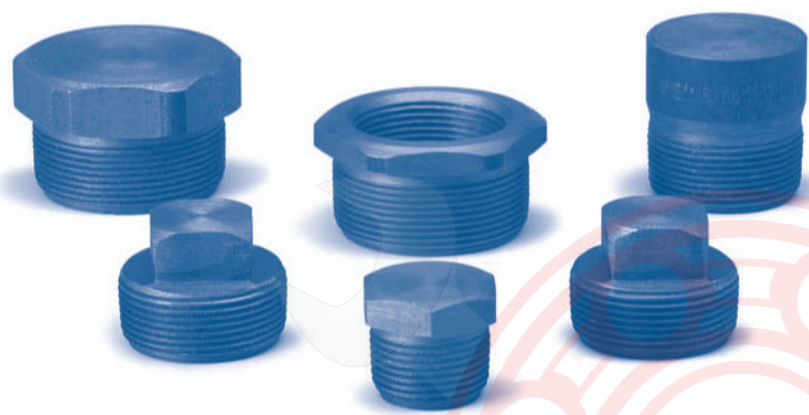

DIMENSIONS (inches)												
NOMINAL PIPE SIZE	1/8	1/4	3/8	1/2	3/4	1	1 1/4	1 1/2	2	2 1/2	3	4
A	13/8	15/8	15/8	13/4	13/4	2	2	2	2 1/2	23/4	23/4	3
B	13/32	17/32	11/16	27/32	11/16	15/16	111/16	129/32	23/8	27/8	3 1/2	4 1/2
C *	7/16	5/8	11/16	7/8	11/16	17/16	113/16	2	2 1/2	3	3 3/4	4 5/8
D	1/4	1/4	5/16	5/16	3/8	3/8	9/16	5/8	11/16	3/4	13/16	1 1/4
E	7/16	1/2	9/16	11/16	3/4	27/32	7/8	15/16	1	1 1/4	19/16	121/32
F	9/32	3/8	7/16	9/16	5/8	13/16	15/16	11/8	15/16	1 1/2	111/16	2 1/2
G	1/4	1/4	5/16	3/8	7/16	1/2	9/16	5/8	11/16	3/4	13/16	1 1/4
H	3/8	7/16	1/2	9/16	5/8	3/4	13/16	13/16	7/8	11/16	1 1/8	13/8
J		5/8	11/16	7/8	11/16	17/16	113/16	2	2 1/2	3	3 3/4	4 5/8
K		3/16	3/16	3/16	1/4	1/4	3/8	3/8	3/8	1/2	13/16	1 1/4
L		1/2	9/16	11/16	3/4	27/32	7/8	15/16	1	1 1/4	19/16	121/32
M		7/16	1/2	9/16	5/8	3/4	13/16	13/16	7/8	11/16	1 1/8	1 1/4
N	3/8	7/16	1/2	9/16	5/8	3/4	13/16	13/16	7/8	11/16	1 1/8	1 1/4
WEIGHT (pounds)												
ROUND HEAD PUGS	.125	.125	.188	.250	.375	.750	1.125	1.563	3.00	4.75	7.62	12.87
HEXAGON PLUGS	.063	.063	.125	.188	.313	.500	1.125	1.375	2.25	3.87	5.87	13.00
SQUARE HEAD PLUGS	.016	.031	.063	.125	.188	.313	.563	.875	1.50	2.25	2.87	7.18
HEXAGON BUSHINGS		.063	.063	.063	.125	.188	.375	.688	1.62	2.37	3.50	8.31
FLUSH BUSHINGS		.063	.063	.063	.125	.125	.125	.188	.37	.62	1.00	2.00

* Dimension J for Hex Head Bushing and dimension C for Hex Head Plug are the same.





CLASS 3000

CLASS 6000

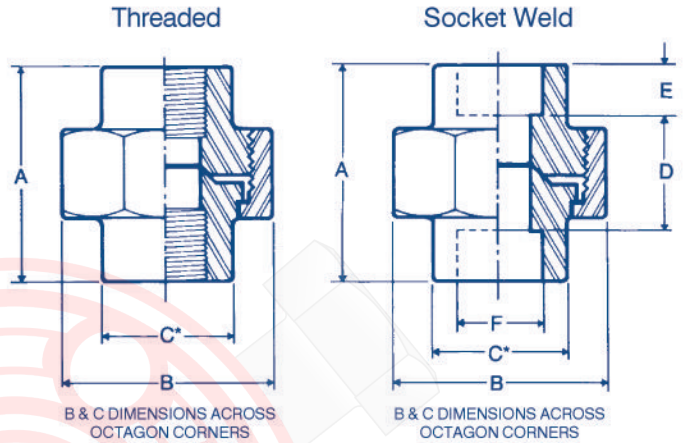
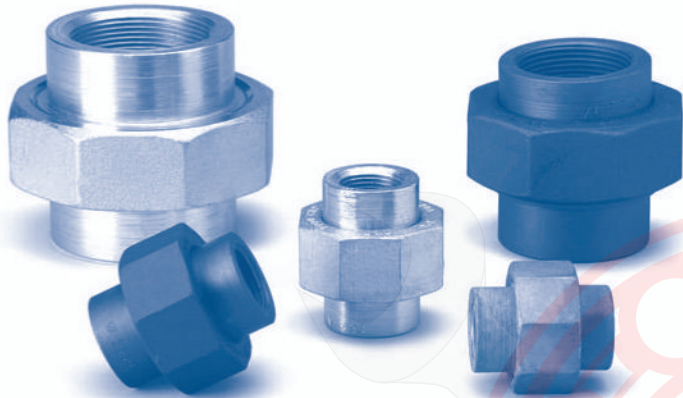

* "C" dimension is across octagon corners or a diameter as applicable. The 2 1/2" and 3" 3000 and 2" 6000 sizes have octagonal male and female ends; the other sizes are round.

DIMENSIONS (inches)												
CLASS 3000	NOMINAL PIPE SIZE	1/8	1/4	3/8	1/2	3/4	1	1 1/4	1 1/2	2	2 1/2	3
	A	1 11/16	1 11/16	1 27/32	2	2 5/16	2 7/16	2 7/8	3	3 1/2	4 1/4	4 7/16
	B	1 31/64	1 31/64	1 11/16	1 15/16	2 3/8	2 25/32	3 23/64	3 23/32	4 27/64	5 15/64	6 5/32
	C	53/64	53/64	1	1 3/16	1 15/32	1 25/32	2 7/32	2 35/64	3 1/16	3 9/16	4 9/32
	D	25/32	25/32	31/32	1 3/32	1 5/32	1 3/8	1 45/64	1 7/8	2 1/16	2 3/8	2 7/16
	E	7/16	7/16	7/16	7/16	9/16	9/16	9/16	9/16	11/16	7/8	1
	F	.420	.555	.690	.855	1.065	1.330	1.675	1.915	2.406	2.906	3.535
	WEIGHT PER UNION (pounds)											
		.38	.36	.50	.695	1.175	1.64	2.59	3.41	5.12	8.75	12.625

DIMENSIONS (inches)												
CLASS 6000	NOMINAL PIPE SIZE	1/8	1/4	3/8	1/2	3/4	1	1 1/4	1 1/2	2		
	A	1 11/16	1 27/32	2	2 5/16	2 7/16	2 7/8	3	3 1/2	4 1/8		
	B	1 31/64	1 11/16	1 15/16	2 3/8	2 25/32	3 23/64	3 23/32	4 27/64	5 15/64		
	C	53/64	1	1 3/16	1 15/32	1 25/32	2 7/32	2 35/64	3 1/16	3 9/16		
	D	25/32	31/32	1 3/32	1 5/32	1 3/8	1 45/64	1 7/8	2 1/16	2 3/8		
	E	7/16	7/16	7/16	9/16	9/16	9/16	9/16	11/16	7/8		
	F	.420	.555	.690	.855	1.065	1.330	1.675	1.915	2.406		
WEIGHT PER UNION (pounds)												
		.5	.56	.75	1.25	1.75	3	3.75	6.0	10.5		





TYPE 601

TYPE 602

TYPE 602B

TYPE 604

- Ball to cone seats for smooth alignment.
- Can be cracked and rejoined- repeatedly.
- Replaceable, interchangeable parts.
- Carbon Steel, coated to resist corrosion.
- Stays sealed, despite shock, vibration, expansion and rough wrenching.
- Silicon bronze and stainless steel seats double locked under 120,000 lb. psi.
- Conveniently packaged.
- Suitable for use with Schedule 40/80 pipe.
- 100% hydro tested.

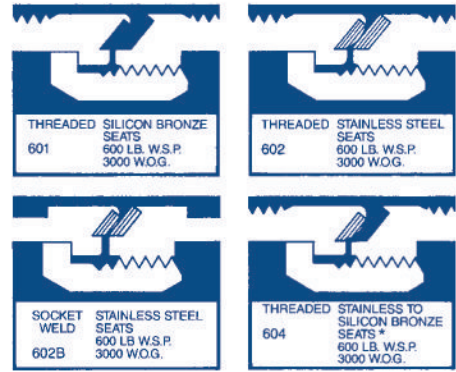

* Preferred over bronze to carbon steel seated unions.

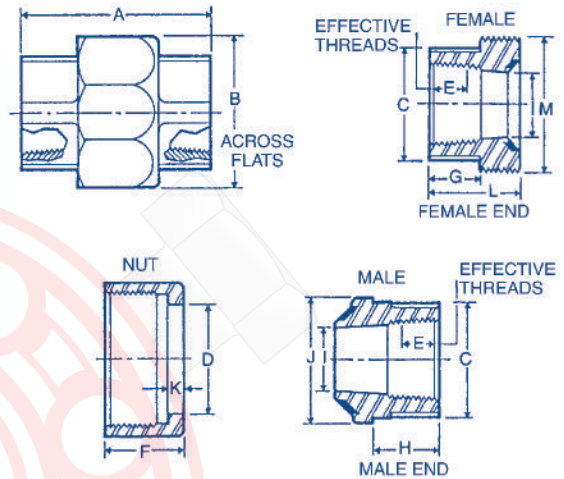
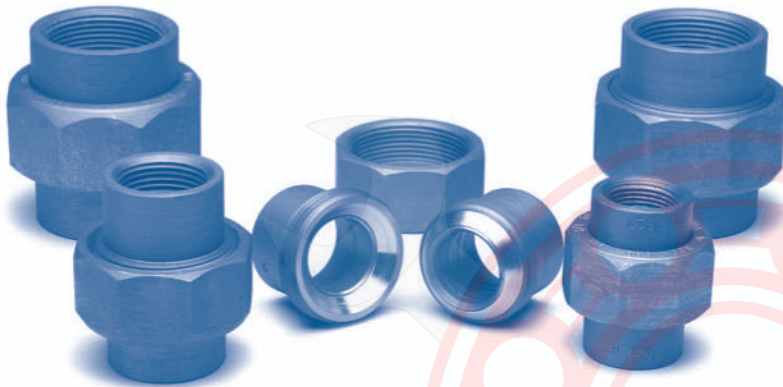

TYPE 601, 602, 604	DIMENSIONS (Inches)									
	NOMINAL PIPE SIZE	1/8 18-NPT	1/4 18-NPT	3/8 18-NPT	1/2 14-NPT	3/4 14-NPT	1 11/2-NPT	1 1/4 11/2-NPT	1 1/2 11/2-NPT	2 11/2-NPT
	A	1 3/4	1 3/4	2	2 1/4	2 7/16	2 11/16	2 31/32	3 1/8	3 11/16
	B	1 1/4	1 1/4	1 7/16	1 21/32	2	2 3/8	2 3/4	3	3 23/32
	C	3/4	3/4	7/8	1 3/32	1 25/64	1 5/8	2	2 9/32	2 51/64
	D	51/64	51/64	15/16	1 11/64	1 7/16	1 23/32	2 3/32	2 11/32	2 7/8
	E	.264	.402	.408	.534	.548	.683	.707	.724	.757
	F	3/4	3/4	13/16	1	1 1/16	1 3/32	1 19/64	1 21/64	1 15/32
	G	1/2	1/2	9/16	11/16	3/4	27/32	7/8	1	1 7/32
	H	19/32	19/32	3/4	25/32	29/32	1 1/16	1 5/32	1 7/32	1 7/16
I	21/64	3/8	1/2	5/8	29/32	1 1/16	1 13/32	1 21/32	2 1/16	
J	29/32	29/32	1 1/16	1 5/16	1 37/64	1 13/16	2 1/4	2 1/2	3 1/16	
K	1/8	1/8	1/8	3/16	7/32	7/32	9/32	9/32	19/64	
L	7/8	7/8	15/16	1 1/8	1 3/16	1 5/16	1 7/16	1 1/2	1 25/32	
M	1.035	1.035	1.164	1.437	1.693	1.975	2.416	2.649	3.221	
STYLE NUT	Hex	Hex	Hex	Hex	Octagon	Octagon	Octagon	Octagon	Octagon	
WEIGHT PER UNION (pounds)										
	.32	.30	.40	.72	1.10	1.5	2.2	2.6	4.6	

TYPE 602B	DIMENSIONS (Inches)									
	NOMINAL PIPE SIZE	1/8 18-NPT	1/4 18-NPT	3/8 18-NPT	1/2 14-NPT	3/4 14-NPT	1 11/2-NPT	1 1/4 11/2-NPT	1 1/2 11/2-NPT	2 11/2-NPT
	DEPTH SOCKET	7/16	7/16	7/16	1/2	1/2	9/16	9/16	9/16	11/16
	SOCKET DIAMETER	.420	.555	.690	.855	1.065	1.330	1.675	1.915	2.406
	STYLE NUT	Hex	Hex	Hex	Hex	Octagon	Octagon	Octagon	Octagon	Octagon
WEIGHT PER UNION (pounds)										
	.32	.30	.40	.72	1.10	1.5	2.2	2.6	4.6	





CLASS 3000

CLASS 6000

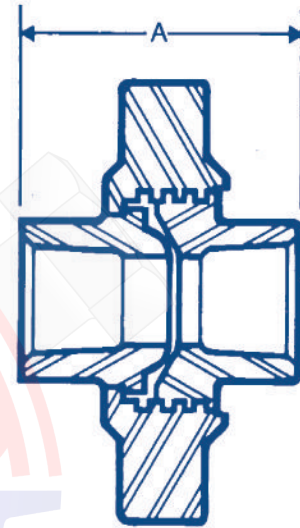
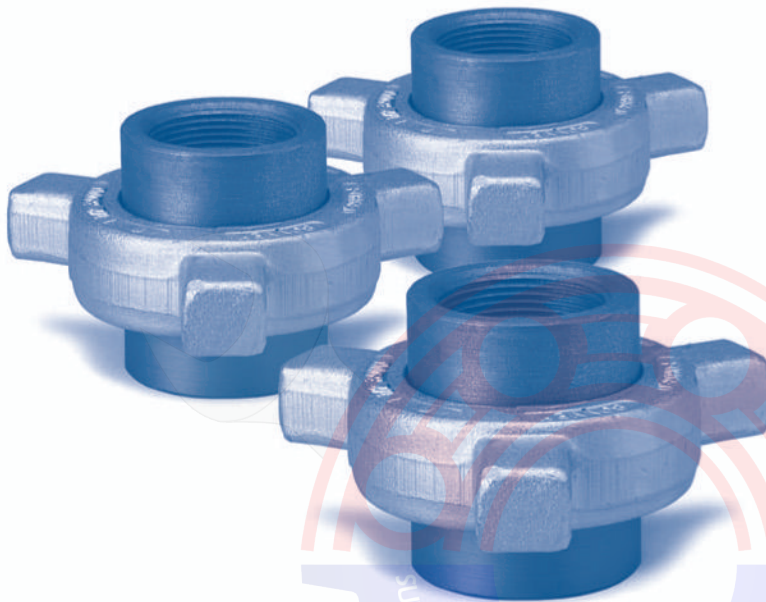

Lug Nut Unions from Bonney Forge are unions with modified Stub-Acme threads ideal for applications requiring rapid assembly and/or breakdown.

- Threaded and socket weld ends.
- Seating characteristics of AAR unions.
- Twin lugs in sizes up to 3/4" Class 3000 and 1/2 Class 6000.
- Tri-lug design in sizes from 1" - 4" Class 3000 and 3/4" - 2" Class 6000.
- Plated Lug Nut.

DIMENSIONS (inches)		A	A
NOMINAL PIPE SIZE			
3/8	CLASS 3000	1.950	CLASS 6000
1/2		2.065	
3/4		2.375	
1		2.580	
1 1/4		2.950	
1 1/2		3.115	
2		3.575	
2 1/2		4.200	
3		4.475	
4		8.50	





SUMINISTROS INDUSTRIALES DÍAZ



Av. Puebla 515
Col. Palma Sola, CP 93320
Poza Rica Veracruz, México

Teléfonos

7821606595
7821604051
7821610766



www.sidiaz.com



Suministros Industriales Díaz



contacto@sidiaz.com



@SiDiazMex



@sidiazmex



Suministros Industriales Díaz